

## DOOR EDGE OPTIONS

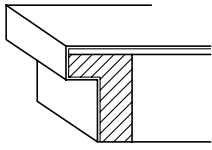

### Rectangular edge

The simplest edge style accentuates a timeless, minimalistic design. This edge is available for all rebate configurations and door constructions.

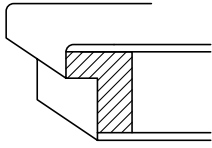

### Postforming round edge

Postformed edges are particularly dirt-resistant, thanks to the seamless transition between the surface and the edge. This edge is available for flush closing doors type 40/type 43 up to a size of 2110 x 985 mm.

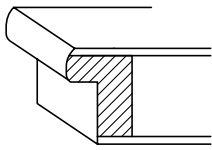

### Segmental arch edge

The segmental arch edge is characterised by a soft transition between the surface and the edge. This edge is available for rebated doors type 40/type 43 up to a size of 2110 x 985 mm.

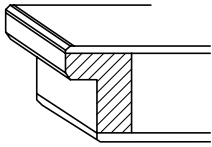

### Soft edge

The two-millimetre bevelled edge is often used in pre-schools and nursing homes, in accordance with accident prevention and insurance requirements, to minimise the risk of injury. This edge is available for flush closing doors and rebated doors type 40/type 43/type 50.

## DOOR EDGE OPTIONS FOR SURFACES AND DESIGNS

Version		Rectangular edge	Postforming round edge	Segmental arch edge	Soft edge
Surfaces	Homapal	•			
	FENIX NTM	•			
	FENIX NTA	•			
	Getalit	•			•
	Portalit	•	•		
	Dekorit*	•	•		
	Westalack Premium	•		•	
	Westalack Soft	•	•		
	Westalack Smart	•	•		
Design	View	•	•	•	
	Westaline	•		•	
	Velvet Line	•	•		
	Lineo	•	•	•	
	Provence	•		•	
	Bretagne	•		•	
	Piemont	•	•		

\* DEC 11 and DEC 44 not available as round edge